

Svecia Autopiles, SAP, are automatic stackers designed for multi-purpose operations and will handle all types of materials used in screen printing, from thin paper and plastics to board and metal sheets. Wide conveyor belts, together with a powerful adjustable air cushion system and variable conveyor speeds, ensure trouble-free delivery to the pile. Photo-optic controlled side-joggers provide continuous and smooth sheet stacking and sensors ensure automatic sheet delivery height. Svecia Autopiles are available in three different versions:

## **TYPE A, SAP-A**

is usually used with three-quarter automatic screen printing lines for medium to large size materials. It can be unloaded from the back or from either side, a space saving feature. A large mirror allows the operator to have perfect visibility from printing press to stacker.

## **TYPE B, SAP-B**

is a further development of SAP-A and is usually used in fully automatic screen printing lines. Besides the features of SAP-A, the length of the infeed conveyor is adjustable. This feature eliminates manual loading of the feeder for second or subsequent print runs, as the full pallets can be transferred directly from stacker to feeder.

## **TYPE C, SAP-C**

is a compact stacker, specially designed for small printing sizes from 550x750 to 765x1070 mm.

### **Standard equipment:**

- Variable conveyor speed 0-60 m/min.
- Photo-optic controlled side joggers.
- Automatic pile height control.
- Counter with reset function.
- 100 mm wide anti-statically treated conveyor belts.
- Mirror for visibility from printing press to stacker.
- Signal lamp warning for full pile.

### *For SAP-A and SAP-B also;*

- Back or either side loading.

### *For SAP-B also;*

- Variable adjustable length of infeed conveyor eliminating manual loading of feeder for subsequent print runs.



**SVECIA** – Your partner for better performance

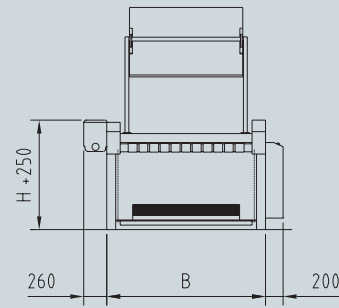
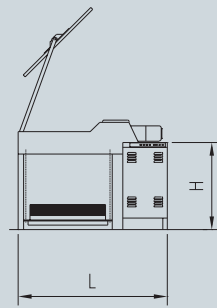

**Technical Data**

**SAP-A/SAP-B**

Model Code/Size (mm)	Max. mtrl. size (mm)	Min. mtrl. size (mm)	B (mm)	L (mm)
765x1070 (A only)	765x1070	350x250	1780	1675
1050x1450	1050x1450	350x250	2030	1875
1450x1850	1450x1850	350x250	2430	2275
1650x2150	1650x2150	350x250	2780	2525
1650x2650	1650x2650	350x250	3280	2525

Electrical specification at 3-phase, 50Hz, 380V (220V): 2kW, 6A (10A)

H is the conveyor belt height, depending on the belt height of connected dryer. Total pile heights is 180 mm less than the conveyor belt height above floor level. Max. stock weight is 1500 kg up to format 1050x1450. For formats above 1050x1450, deduct 200 mm from conveyor belt height. Max. stock weight is 3000 kg.

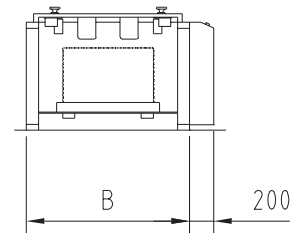
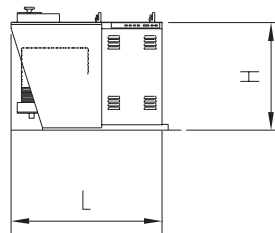

**SAP-C**

Model Code/Size (mm)	Max. mtrl. size (mm)	Min. mtrl. size (mm)	B (mm)	L (mm)
550x750	550x750	350x250	1350	1260
650x900	700x900	350x250	1500	1360
765x1070	765x1070	350x250	1650	1460

Electrical specification at 3-phase, 50Hz, 380V (220V): 2kW, 6A (10A)

H is the conveyor belt height, depending on the belt height of connected dryer. Total pile height is 130 mm less than the conveyor belt height above floor level. Max. stock weight is 1500 kg.

Please note:

Svecia's policy is one of continuous improvement and accordingly the manufacturer reserves the right to change specifications without prior notice.

Date: 01-09-10

**SVECIA**

**SVECIA SCREEN PRINTING AB**

Kumla gårdsväg 21A  
145 81 Norsborg-Stockholm  
Sweden  
Tel +46-(0)8-531 930 00  
Fax +46-(0)8-531 930 99  
E-mail public@svecia.se  
www.svecia.com

**SVECIA EAST LTD.**

8/F, Leahander Center  
28 Wang Wo Tsai Street, Tsen Wan, Hong Kong  
Tel +852-2614 2963  
Fax +852-2614 4693  
E-mail svecia@netvigator.com

**SVECIA INDUSTRIAL SYSTEMS S.R.L.**

Via Emilia, 21  
I-26862 Guardamiglio (LO), Italy  
Tel +39-0377 519037-519045  
Fax +39-0377 451104  
E-mail sveciaeuropa.it@tin.it

**SVECIA ESPAÑA S.A.**

c/Aluminio 5, Pol.Ind. Finanzauto  
28500 Arganda del Rey, Madrid, Spain  
Tel +34-91-87 17 120  
Fax +34-91-87 15 910  
E-mail trodrigo@furnet.es

**SVECIA SIEBDRUCKTECHNIK GmbH**

Mühlach 11  
90552 Röthenbach/Peg, Germany  
Tel +49-911-95 78 90  
Fax +49-911-57 87 39  
E-mail info@svecia.de

**SVECIA FRANCE SARL**

17, Rue Alfred de Musset  
77176 Savigny-Le-Temple, France  
Tel +33-1-64 89 73 60  
Fax +33-1-64 89 73 61  
E-mail sveciafrance@aol.com

**SVECIA USA, INC.**

7 Fir Court  
Oakland, New Jersey 07436, USA  
Tel +1-201-337 7786  
Fax +1-201-337 1046  
E-mail sales@svecia.com